

#	QTY	PART #	KEY	DESCRIPTION	#	QTY	PART #	KEY	DESCRIPTION
1	1	0182-87		VALVE SEAT	25	1	0120-98		WASHER
2	2	0060-02	①	O-RING	26	1	0624-93		RETAINER, DIAPHRAGM
3	1	0182-88		ADAPTOR- VALVE SEAT	27	1	0513-94		TOP COVER, QUANT. BLACK
4	1	0060-22	①	O-RING	28	1	0513-95		TOP COVER, QUANT. YELLOW
5	1	0226-01	①	L.P. SEAT	29	1	0232-26		DECAL/INSERT ASSM BLUE
6	2	0060-61	①	O-RING	30	1	0232-25		DECAL/INSERT ASSM. BLACK
7	1	0624-97		SEAT CARRIER	31	1	0229-39		HOSE ASSM. 29" IN-LINE ADJ.
8	1	0040-77		SPRING	32	1	0229-40		HOSE ASSM. 39" IN-LINE ADJ.
9	1	0624-98		FLOW TUBE	33	1	0121-02		FRICTION WASHER
10	1	0625-78		FLOW TUBE NON-ADJUSTABLE					
11	1	0250-22	①	RETAINING RING					
12	1	0060-95		O-RING					
13	1	0300-67		MOUTHPIECE					
14	1	0310-11	①	CLAMP					
15	1	0624-96		BALANCE CHAMBER					
16	1	0060-96	①	O-RING					
17	1	0625-05		SHAFT					
18	1	0625-61	①②	CLIP, RETAINER					
19	1	0625-04		CAP					
20	1	0612-80		BOTTOM BOX					
21	1	0170-91		LEVER S.S.					
22	1	0624-91		CORE, DIAPHRAGM					
23	1	0050-18		DIAPHRAGM ASSEMBLY					
24	1	0240-14		EXHAUST VALVE					
25	1	0624-92		RETAINER, DIAPHRAGM CORE					

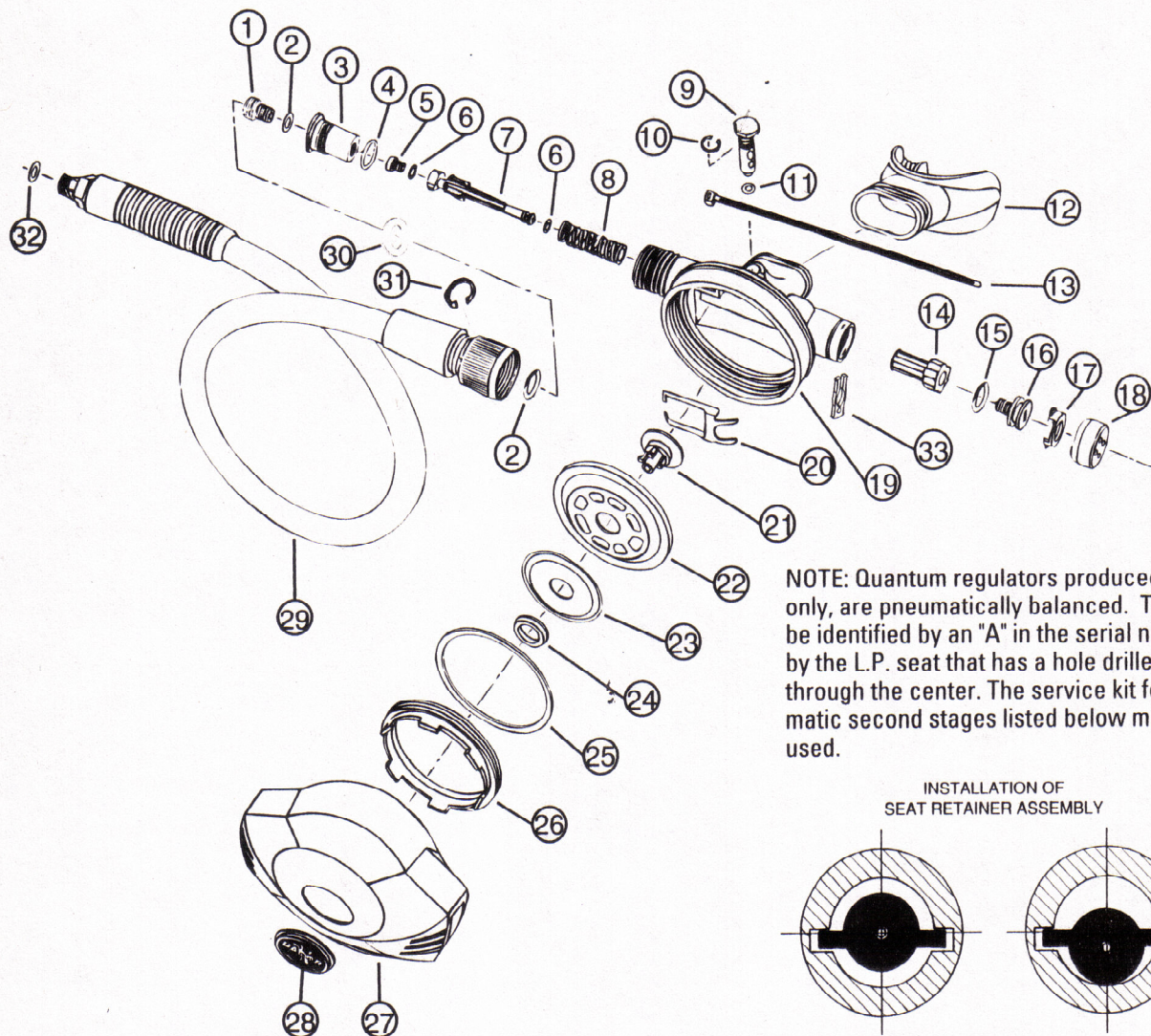

NOTE: Quantum regulators produced in 1992 only, are pneumatically balanced. They can be identified by an "A" in the serial number or by the L.P. seat that has a hole drilled through the center. The service kit for pneumatic second stages listed below must be used.

INSTALLATION OF SEAT RETAINER ASSEMBLY

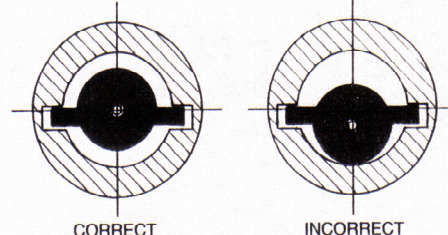

1992 QUANTUM PNEUMATIC
SECOND STAGE

9/93

Second Stage
Regulators

PAGE

2-38

KEY

① Included in annual service kit #9680-22
② 0628-02 Clip retainer (33) replaces 0625-61
retainer, clip (17).