

SCUBAPRO

Technical Service Schematic

MK 10 FIRST STAGE #10-500-000
MK 9 FIRST STAGE #10-400-000

Parts

Date 9/94 Revision E
 Annual Repair Parts Kit #10-500-041

#	QTY	PART #	DESCRIPTION	COST	
1	1	10-101-106	SEAT RETAINER		
2	1	01-050-157	O-RING, SEAT RETAINER, RED		
3	1	10-101-151	SEAT, HP, CAVE CONE	6.00	
* 4	1	01-050-147	O-RING, HP SEAT, PURPLE		
5	1	10-500-108	BODY, MK10, MK9		
6	2	10-101-139	HP PLUG, 7/16-20		
7	3	01-050-138	O-RING, HP PLUG, YOKE RTNR, BLUE		
8	2	10-101-039	HP PLUG, 7/16-20 WITH O-RING		
9	1	01-050-137	O-RING, PISTON SHAFT, AMBER	2.05	
* 10	3	01-060-101	WASHER		
11	1	01-020-217	SPRING 10-400-004, 1/8"		
12	1	10-500-003	PISTON	22.00	
13	1	01-050-162	O-RING, PISTON, LARGE, AMBER	2.08	
14	1	01-050-217	O-RING, CAP, BLUE		
15	1	0	10-500-103	SWIVEL RETAINER	
16	1	0	01-060-500	WASHER, SWIVEL	
17	1	0	10-500-101	CAP, SWIVEL	
18	1	0	01-050-161	O-RING, SWIVEL, BLUE	
19	4	4	10-101-104	LP PLUG, 3/8-24	
20	4	4	01-050-132	O-RING, LP PLUG, BLUE	
21	4	4	10-101-006	LP PLUG, 3/8-24 WITH O-RING	
22	1	0	10-500-102	SWIVEL, 5-PORT	
23	0	1	10-400-105	CAP, NON SWIVEL, 5-PORT	
24	1	1	10-400-103	SADDLE	
25	1	1	10-101-211	HP PROTECTOR	
26	1	1	10-101-131	YOKE, 9/16, POLISHED	
27	1	1	10-200-008	YOKE SCREW ASSY, 9/16	10.10
28	1	1	10-101-132	YOKE SCREW, 9/16, (OLD STYLE)	
29	1	0	01-006-510	DECAL, MK10	
30	1	1	10-400-104	YOKE RETAINER	
31	1	1	01-028-109	FILTER, CONICAL	2.00
32	1	1	01-073-101	FILTER RETAINER	1.00
33	1	1	01-050-193	O-RING, DIN ADAPTER, BLACK	
34	1	1	10-400-107	RETAINER, DIN, 300 BAR	
35	1	1	10-105-118	KNOB, 300 BAR	
36	1	1	01-060-501	WASHER, DIN	
37	1	1	01-050-142	O-RING, DIN RETAINER, AMBER	
○ 38	1	1	10-400-030	KIT, DIN, 300 BAR	
○ 40	1	1	10-500-105	SPEC BOOT, MK10, MK9	
○ ●	1	1	10-500-020	SPEC BOOT KIT W/SILICONE GREASE	
○ ●	1	1	10-500-021	E.A.N., CONVERSION KIT (NITROX)	
		MK10 #10-500-000			
		MK9 #10-400-000			

Technical Information:

Special Engineering Notes:

Item #4, 01-050-147 o-ring can be installed with the aid of a 3/8" nut driver. To properly locate this o-ring, lightly lubricate it, then place it into the body and chase it with the end of the nut driver to fully seat it. Apply a light downward pressure using a rocking action. Remove the nut driver and inspect the o-ring position. It should be located completely into the recess.

Maximum of 3 washers #01-060-101 may be used to adjust intermediate pressure to specified limits.

Flow through piston designs will under some conditions make a whistling noise during flow. To alleviate, replace Item #3 HP seat, and heavily lubricate Item #9, 01-050-137 o-ring.

Legend (prices subject to change without notice)

- Not Shown ◇ Dynamic O'Ring Replace Annually
- Optional Item ◊ Annual Replacement
- ▲ Limited Warranty [] Torque In Inch Pounds
- Older Configuration * See Note

SCUBAPRO

Technical Service Schematic

MK 10 FIRST STAGE #10-500-000
MK 9 FIRST STAGE #10-400-000

Date 9/94 Revision C
Annual Repair Parts Kit #10-500-041

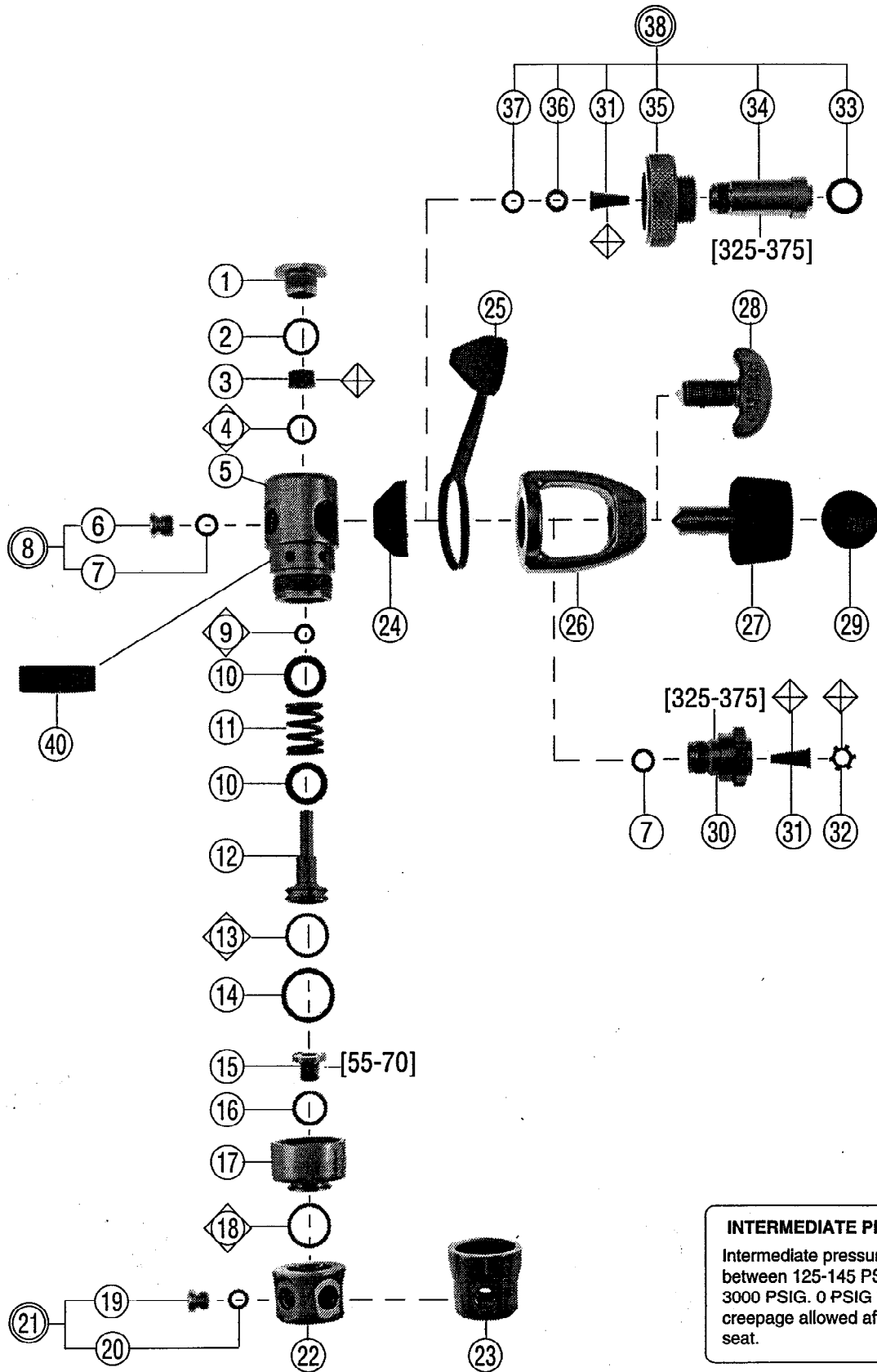

INTERMEDIATE PRESSURE LIMITS
Intermediate pressure limits must be between 125-145 PSIG at both 300 and 3000 PSIG. 0 PSIG intermediate pressure creepage allowed after seating of new seat.