

SCUBAPRO

Technical Service Schematic

MK 7 FIRST STAGE 10-107-000

Date 9/94 Revision S
Annual Repair Parts Kit #10-107-041

Parts

#	QTY	PART #	DESCRIPTION	COST
○ 1	1	10-200-008	YOKE SCREW ASSY, (9/16)	
* 2	1	10-101-132	YOKE SCREW, (9/16)	
□ ●	1	10-101-113	YOKE SCREW, (7/16)	
□ ●	1	10-101-130	YOKE SCREW, (3/8)	
3	1	10-107-104	RETAINER, OSCILLATOR	
4	1	01-050-179	O-RING, RETAINER	
5	1	01-020-106	SPRING, OSCILLATOR	
6	1	10-107-006	OSCILLATOR ASSY	
7	1	01-050-322	O-RING, OSCILLATOR, BLACK & WHITE	
8	1	01-050-152	O-RING, OSCILLATOR FACE, BLACK	
9	N/A	10-101-110	INLET PROTECTOR	
10	1	01-050-138	O-RING, HP PLUG, BLUE	
11	1	10-101-139	PLUG, HP, (7/16-20)	
12	1	10-101-039	PLUG, HP, (7/16-20) WITH O-RING	
13	1	10-101-106	SEAT RETAINER	
14	1	01-050-157	O-RING, SEAT RETAINER, RED	
15	1	10-101-151	SEAT, CAVE CONE	
* 16	1	01-050-147	O-RING, HP SEAT, PURPLE	
17	N/A	01-006-133	DECAL	
18	N/A	01-006-120	DECAL, WARNING	
19	N/A	10-107-002	BODY	
20	2	01-050-127	O-RING, HP STEM	
21	1	10-107-107	SPRING PAD	
22	1	01-020-107	SPRING	
23	1	10-107-108	STEM	
24	1	10-107-109	RETAINER, STEM	
25	1	01-050-137	O-RING, PISTON SHAFT, AMBER	
* 26	2	01-060-101	WASHER	
27	1	01-020-101	SPRING, PISTON	
28	1	10-101-003	PISTON	
29	1	01-050-179	O-RING, PISTON, AMBER	
30	1	01-050-184	O-RING, PISTON RETAINER, RED	
31	1	10-107-103	RETAINER, PISTON	
32	1	01-050-132	O-RING, LP PLUG, BLUE	
33	1	10-101-104	PLUG, LP	
34	1	10-101-006	PLUG, LP WITH O-RING	
35	1	01-073-101	FILTER RETAINER	
36	1	01-028-109	FILTER, CONICAL	
□ 37	1	01-028-101	FILTER, FLAT	
□ 38	1	01-050-144	O-RING, BLUE	

Technical Information:

Item #2 note: The 3/8 and 7/16 yoke screws are for older configuration MK7 bodies which are limited to 2475 psi service.

Special Engineering Notes:

Item #16, 01-050-147 o-ring can be installed with the aid of a 3/8" nut driver. To properly locate this o-ring, lightly lubricate it, then place it into the body and chase it with the end of the nut driver to fully seat it. Apply a light downward pressure using a rocking action. Remove the nut driver and inspect the o-ring position. It should be located completely into the recess.

Maximum of 3 washers #01-060-101 may be used to adjust intermediate pressure to specified limits.

Flow through piston designs will under some conditions make a whistling noise during flow. To alleviate, replace Item #15 HP seat, and heavily lubricate Item #25, 01-050-137 o-ring.

Legend (prices subject to change without notice)

- Not Shown ◇ Dynamic O'Ring Replace Annually
- Optional Item ◇ Annual Replacement
- ▲ Limited Warranty [] Torque In Inch Pounds
- Older Configuration * See Note

SCUBAPRO

Technical Service Schematic

MK 7 FIRST STAGE 10-107-000

Date 9/94 Revision S
Annual Repair Parts Kit #10-107-041

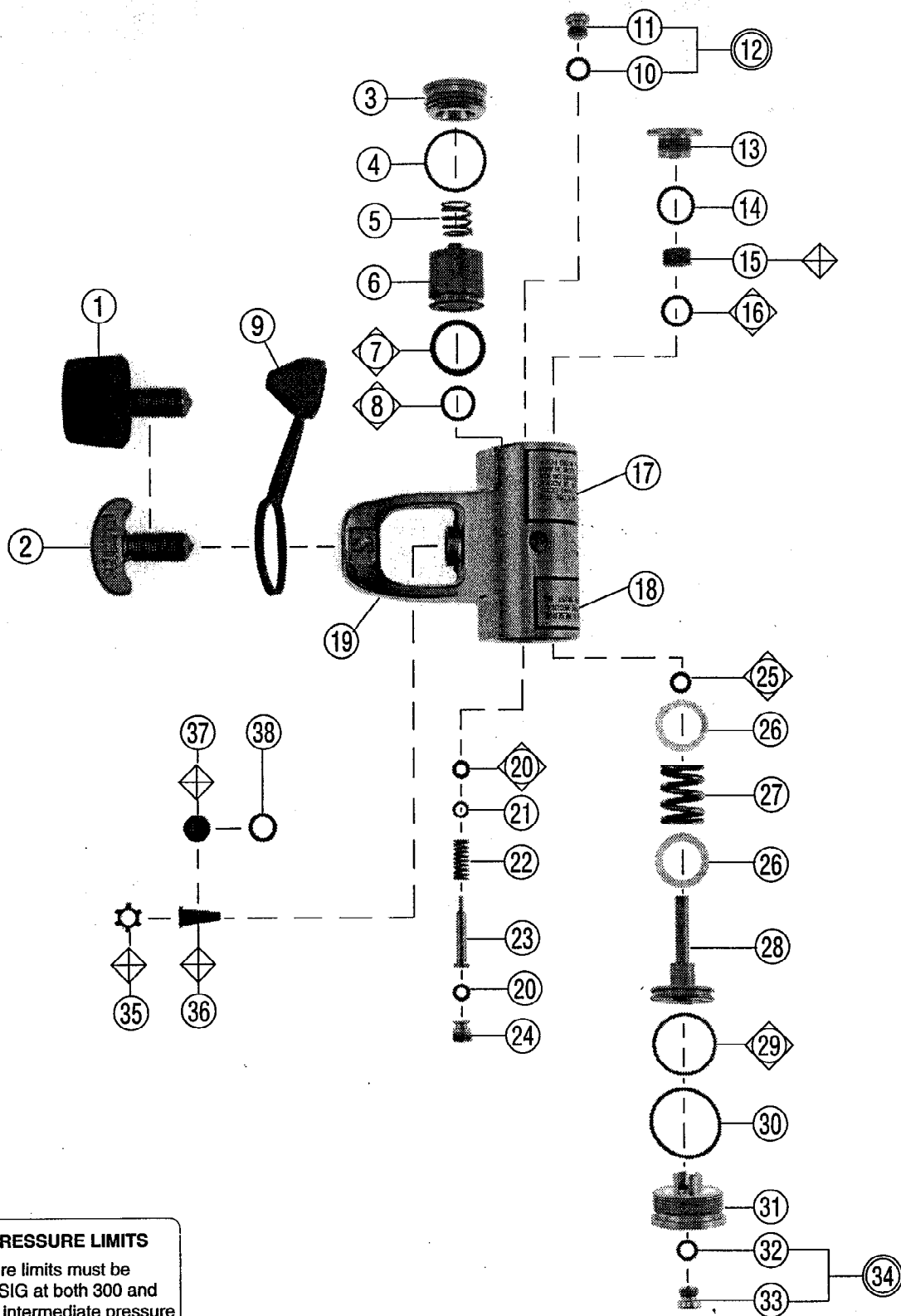

INTERMEDIATE PRESSURE LIMITS

Intermediate pressure limits must be between 125-145 PSIG at both 300 and 3000 PSIG. 0 PSIG intermediate pressure creepage allowed after seating of new seat