

SCUBAPRO

Technical Service Schematic

MK 5 FIRST STAGE 10-105-000

Date 9/94

Revision U

Annual Repair Parts Kit #10-105-041

Parts

#	QTY	PART #	DESCRIPTION	COST
1	1	10-101-106	SEAT RETAINER	8.00 6.50
2	1	01-050-157	O-RING, RED	
3	1	10-101-151	HP SEAT, CAVE CONE	6.00 8.00
* 4	1	01-050-147	O-RING, PURPLE	
5	2	10-101-139	PLUG, HP, (7/16-20)	
6	2	01-050-138	O-RING, HP PLUG, BLUE	
7	2	10-101-039	PLUG, HP, (7/16-20) WITH O-RING	
8	1	01-050-137	O-RING, AMBER	
* 9	2	01-060-101	WASHER	.10
10	1	01-020-101	SPRING, PISTON 01-10-101-002	
11	1	10-101-003	PISTON	31.40
12	1	01-050-179	O-RING, AMBER	
* 13	1	10-105-102	RETAINER, SWIVEL	
14	1	01-060-105	WASHER, SWIVEL	.30
15	1	10-105-114	CAP, SPEC	
16	1	01-050-144	O-RING, BLUE	
17	1	10-105-113	SWIVEL, 5-PORT	
18	4	01-050-132	O-RING, LP PLUG	
19	4	10-101-104	PLUG, LP, (3/8-24)	1.50
20	4	10-101-006	PLUG, LP, (3/8-24) WITH O-RING	2.10
21	1	10-101-141	BODY, MK5	60.00
22	1	10-101-050	SADDLE	
23	1	10-101-211	INLET PROTECTOR	
24	1	10-101-131	YOKE, 9/16 THREAD	
*□ 25	1	10-101-132	YOKE SCREW, 9/16 THREAD	
26	1	10-200-008	YOKE SCREW ASSY, 9/16 THREAD	
27	1	01-006-511	DECAL, MK5	
28	1	01-050-380	O-RING, YOKE RETAINER, AMBER	
29	1	10-101-147	YOKE RETAINER	
30	1	01-028-109	FILTER, CONICAL	.80
31	1	01-073-101	FILTER RETAINER	.50
□ 32	1	01-050-144	O-RING, BLUE	
□ 33	1	01-028-101	FILTER, FLAT	.70
34	1	01-073-108	FILTER RETAINER	.30
35	1	01-073-107	RETAINING RING, DIN	.30
36	1	10-105-118	KNOB, DIN, 300 BAR	
37	1	10-105-116	RETAINER, DIN, 300 BAR	
38	1	01-050-193	O-RING, DIN RETAINER, BLACK	
○ 39	1	10-105-030	DIN CONVERSION KIT, 300 BAR	
40	1	10-105-004	SWIVEL & RETAINER KIT (5 PORT)	14.80

Technical Information:

Item #25 note: This style yoke screw (9/16 thread) is an older configuration and is acceptable for 3000 psi service. The smaller thread size (3/8 and 7/16) yoke screws not shown are for older configuration MK5 yokes which are limited to 2475 psi service, and no longer available. These yokes and screws should be upgraded to the current configuration.

Special Engineering Notes:

Item #4, 01-050-147 o-ring can be installed with the aid of a 3/8" nut driver. To properly locate this o-ring, lightly lubricate it, then place it into the body and chase it with the end of the nut driver to fully seat it. Apply a light downward pressure using a rocking action. Remove the nut driver and inspect the o-ring position. It should be located completely into the recess.

Maximum of 3 washers #01-060-101 may be used to adjust intermediate pressure to specified limits.

Flow through piston designs will under some conditions make a whistling noise during flow. To alleviate, replace Item #3 HP seat, and heavily lubricate Item #8, 01-050-137 o-ring.

Item #13 note: This part has been changed from brass to stainless steel. Replace any brass parts with the stainless design. Brass can be identified by the slight greenish color if corroded, or by scratching the surface to reveal the brass color beneath the chrome plating.

Legend (prices subject to change without notice)

- Not Shown ◇ Dynamic O'Ring Replace Annually
- Optional Item ◊ Annual Replacement
- ▲ Limited Warranty [] Torque In Inch Pounds
- Older Configuration * See Note

SCUBAPRO

Technical Service Schematic

MK 5 FIRST STAGE 10-105-000

Date 9/94 Revision U
Annual Repair Parts Kit #10-105-041

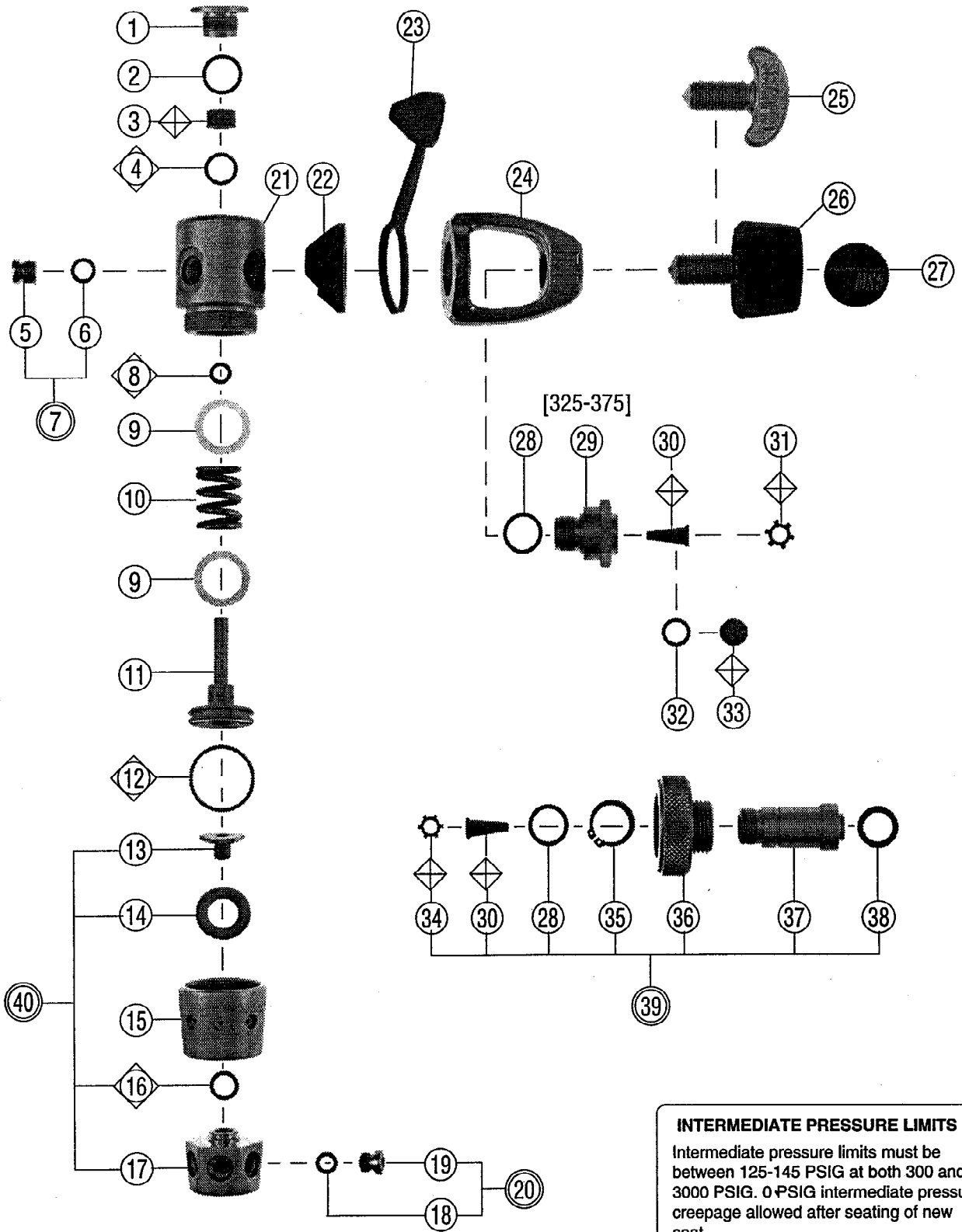

INTERMEDIATE PRESSURE LIMITS
Intermediate pressure limits must be between 125-145 PSIG at both 300 and 3000 PSIG. 0 PSIG intermediate pressure creepage allowed after seating of new seat